

158 Schultz Road WITTA QLD

3  2  4 

Perfectly Placed for a Quiet Country Life!

Situated on a quiet country road amongst the rolling hills of Witta you will find this neat as a pin, colonial style brick home. Set on a North facing, 4000m² block, complete with established gardens, a dam and, plenty of sheds for the home handy man. Tenancy expiring soon, 7th April 2021.

- Easy maintenance, North facing brick home, entertainment areas both front and back

- Large windows for extra light and airflow

- Family size kitchen with freestanding stove with gas cooktop, pantry, plenty of storage and bench space, servery to the covered entertainment area

Building Size : 16 sqm
Land Size : 4000 sqm
View : <https://www.brantandbernhardt.com.au/sale/qld/south/witta/residential/house/6983288>



Susan Brant
0428 573 170

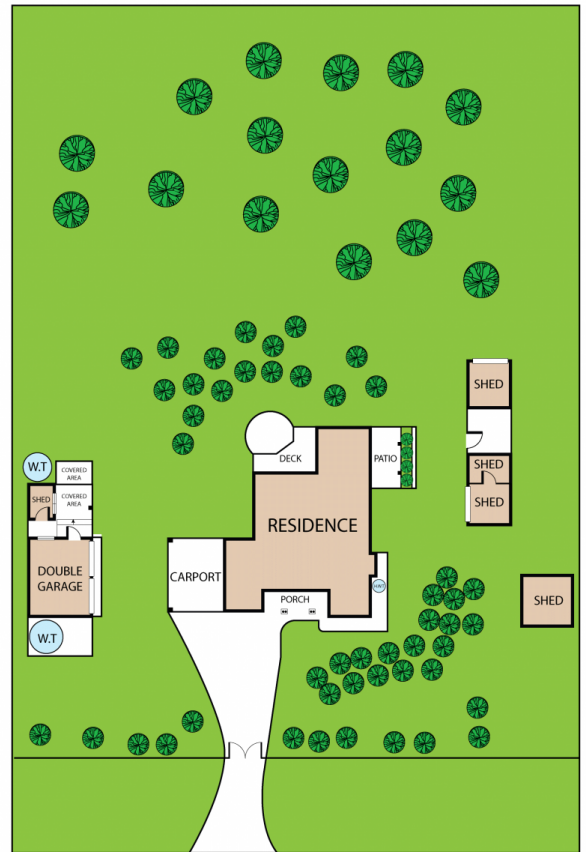

Street Address

TOTAL APPROX. FLOOR AREA 152 SQ.M

Whilst every attempt has been made to ensure the accuracy of the floor plan contained here, measurements of doors, windows, rooms and any other items are approximate and no responsibility is taken for any error, omission, or misstatement. This plan is for illustrative purposes only and should be used as such by any prospective purchaser.